

deli

USER MANUAL

ELECTRIC PENCIL SHARPENER H508

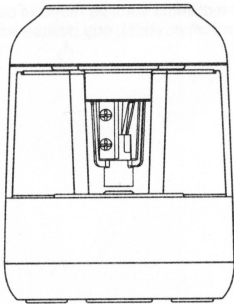

Welcome to use our electric pencil sharpener. To ensure safe operation, please read this manual carefully before use and keep it properly. Please note that we assume no liability for any accidents or injuries caused by misuse or improper use of an electric pencil sharpener. The technical information contained herein is subject to change without notice.

PRODUCT DIAGRAM

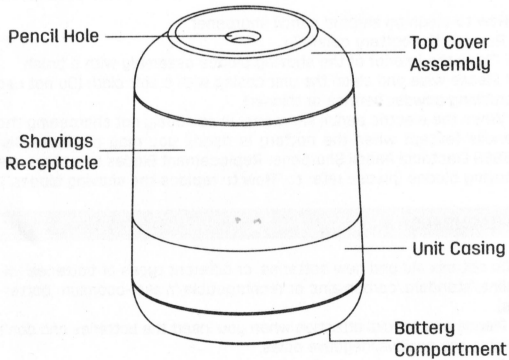

HOW TO INSTALL THE BATTERIES

1. Open the battery compartment door at the bottom of the electric pencil sharpener. (Figure A)
2. Insert 2 AA battery cells into the battery compartment of the electric pencil sharpener. Pay attention to the positive and negative poles, and do not reverse the positive/negative poles. (Figure B)
3. Close the battery compartment door. (Figure C)

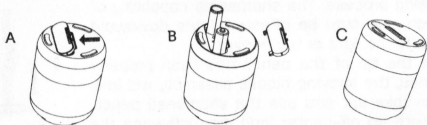

HOW TO REPLACE THE BLADE

1. Turn the top cover assembly counterclockwise. (Figure D)
2. Pull out the blade core downward by force. (Figure E)
3. Align the new shaving blades with the corresponding mating holes in the cover assembly and force the shaving blades into its proper location. (Figure G, H)
4. Align the base hole of the top cover assembly into the unit casing and turn the assembly housing clockwise. (Figure H)

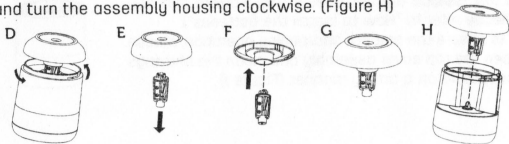

OPERATING INSTRUCTIONS

1. Use a standard wooden pencil (6.5 mm-8 mm in diameter).
2. Hold and insert the pencil vertically into the shaving entrance, slowly increasing the downward pressure until the electric pencil sharpener motor is activated. (Figure I)
3. To ensure the normal sharpening operation, please keep a moderate and steady pressure on the pencil during the sharpening process. The sharpening capability of this sharpener may be affected if the downward pressure is too light or too heavy.
4. Once the tip of the pencil had been properly sharpened, the shaving blades assembly will idle, you can take out and use the sharpened pencil. Pencil with an off-center lead may influence the sharpening effect, but it will not affect the use of the pencil.
5. Please allow the sharpener to cool-down for 5 minutes after a continuous sharpening of 30 pencils, so as to avoid shortening the life of the pencil sharpener.
6. Please reduce the downward pressure if the pencil sharpener's motor speed drops significantly or cease to run; replace the batteries if this problem persists. (Please refer to "How to install the batteries")
7. To ensure the smooth sharpening operation, please open the top cover assembly and clean the shavings receptacle on a timely manner. (Figure J)

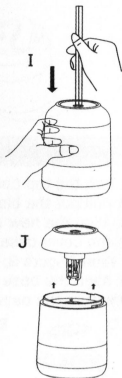

8. When the top cover assembly is removed, the pencil sharpener will not function properly. Place the top cover assembly into its correct position before use.

MAINTENANCE AND CARE

1. How to clean an electric pencil sharpener

1.1 Remove the battery carefully.

1.2 Clean the interior of the shaving blades assembly with a brush.

1.3 Please wipe and clean the unit casing with a soft cloth (Do not use scrubbing powder, benzine or thinner).

2. When the electric pencil sharpener is obviously not sharpening the pencils (except when the battery is dead), you may purchase Deli 68669 Electrical Pencil Sharpener Replacement Blades to replace the shaving blades (please refer to "How to replace the shaving blades").

REMINDERS

1. Do not mix old and new batteries, or different types of batteries (alkaline/standard/carbon zinc or rechargeable/nickel-cadmium batteries).

2. Please pay special attention when you insert the batteries and don't reverse the positive/negative poles.

3. To avoid damage caused by battery liquid leakage, please remove the batteries when you are not using the pencil sharpener for an extended period of time.

4. Do not put your fingers into the pencil hole.
5. Do not touch the helical cutter or you may cut your finger.
6. To avoid any damage to the motor of this unit, please remove the pencil as soon as it is sharpened.
7. Do not disassemble or modify this electric pencil sharpener.
8. This product is only intended for the use of sharpening standard wooden pencils (6.5 mm-8 mm in diameter). It is not intended to be used to sharpen hard materials such as fountain pens and chinks, or soft pens (crayons and oil pastels), any misuse will shorten the life of the blades.

DELI GROUP CO., LTD.

info@nbdeli.com

www.deliworld.com

301 Xuxiake Ave. Ninghai County

Ningbo 315600 China

MADE IN CHINA